



SAN BRUNO RECREATION & AQUATICS CENTER CONCEPTUAL DESIGN

Community Meeting 01

March 22, 2018



GROUP 4



swa



AGENDA

1. Summary Presentation

- Project Workplan
- Summary of Program + Site Options

2. Site Options

- Site Options Preview

3. Break Out Group Discussions

- Program Options
- Site Options
- Design Values
- Report Back

4. Next Steps



AGENDA

1. Summary Presentation

- Project Workplan
- Summary of Program + Site Options

2. Site Options

- Site Options Preview

3. Break Out Group Discussions

- Program Options
- Site Options
- Design Values
- Report Back

4. Next Steps

WORK PLAN

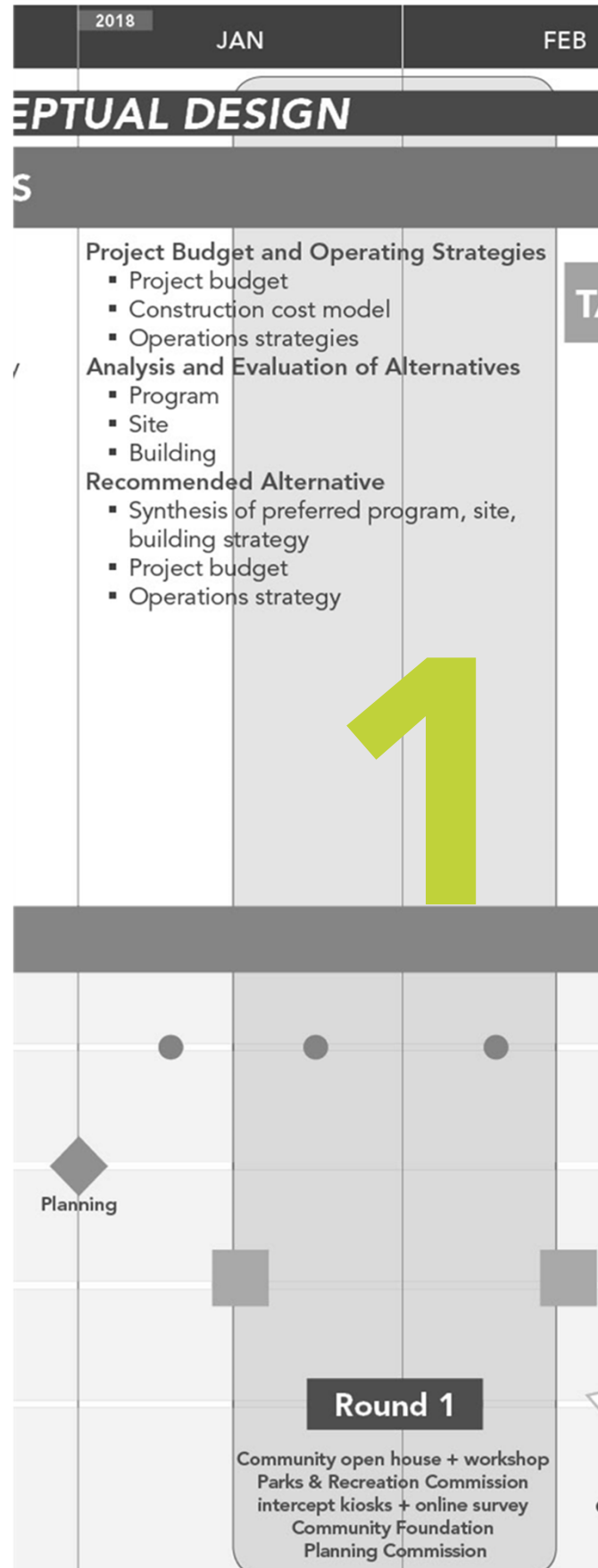

LEVERAGE PAST WORK

Recreation Center

(Could be combined with Community Center or Swimming Pool)



Key Features

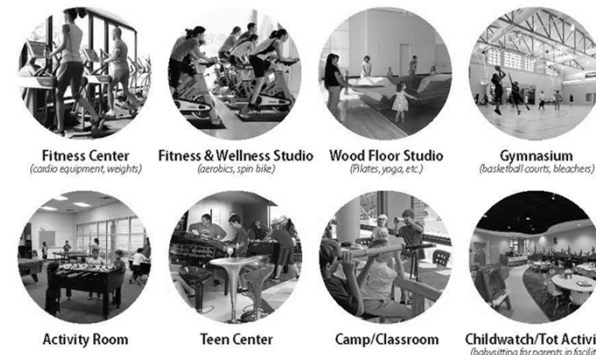

Swimming Pool

(Could be combined with Recreation Center)



Key Features



City of San Bruno
Community Facilities Prioritization

Community Forum #2

November 30, 2016

WORK PLAN



SAN BRUNO RECREATION CENTER AND AQUATICS CENTER PHASE 1 – CONCEPTUAL DESIGN

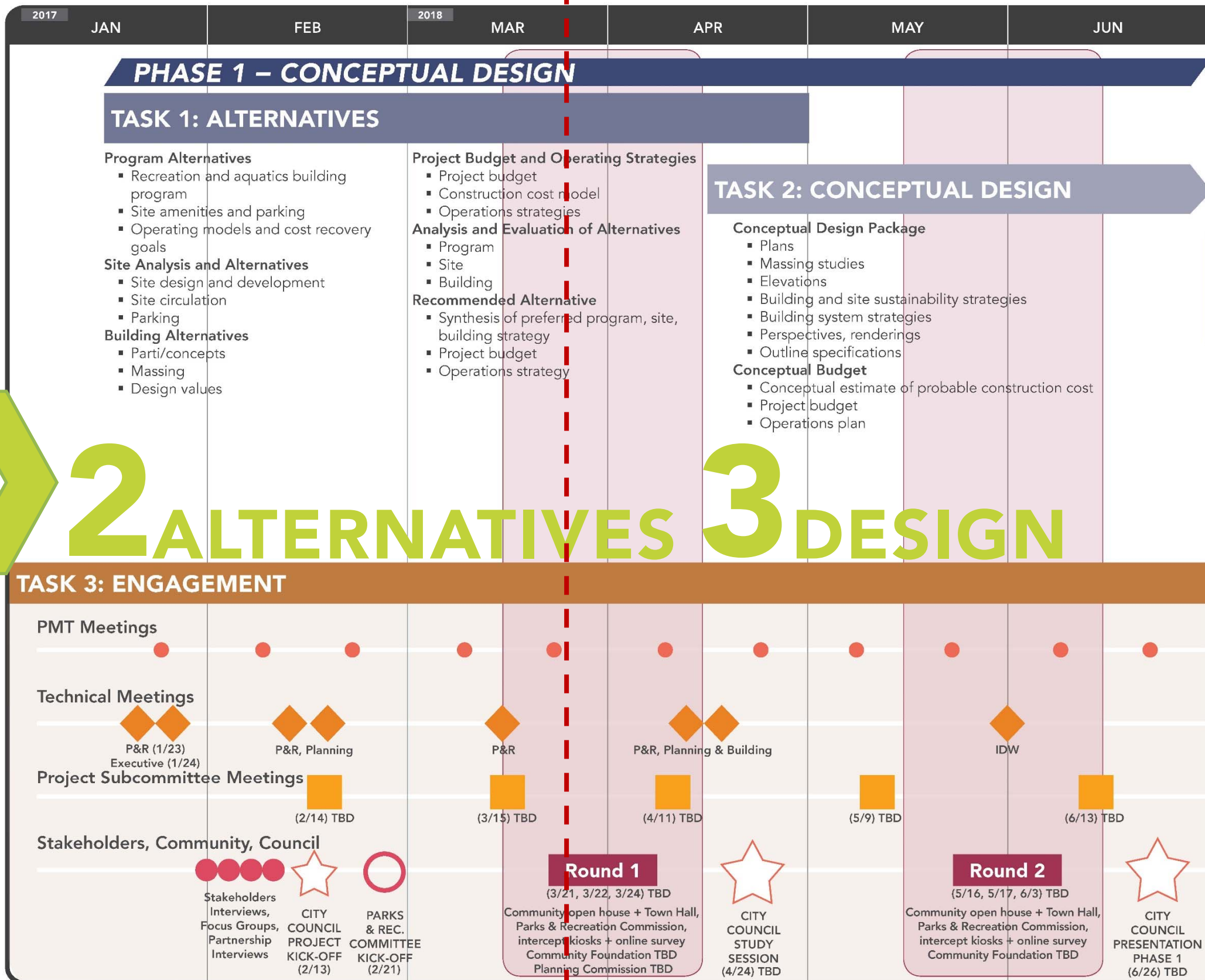

2 ALTERNATIVES 3 DESIGN



PARTICIPATION UPDATES – *Task 1*

Completed:

- ✓ Recreation Staff Technical Meeting 01 – January 23
- ✓ Executive Committee Meeting – January 24
- ✓ City Council Meeting – February 13
- ✓ Advisory Committee 01 – February 20
- ✓ Parks & Recreation Commission Meeting – February 21
- ✓ Recreation Staff Technical Meeting 02 – January 28
- ✓ Planning & Building Department Technical Meetings 01 – March 5
- ✓ Public Works Technical Meeting 01 – March 19
- ✓ Parks & Recreation Commission Meeting 02 – March 21

Upcoming:

- Stakeholder Meetings: *ongoing (50% completed)*
- Round 1 Outreach – March 22: Open House and Community Meeting – TODAY!
- Round 1 Outreach – March 24: Community Intercept Kiosk at Easter Egg Hunt
- April 17: Planning Commission Meeting
- April 24: City Council Presentation



PARTICIPATION UPDATES – *Task 2*

Upcoming:

- **May 16:** Parks & Recreation Commission Meeting 03
- **Round 2 Outreach – May 17:**
 - Community Open House, 3-5PM @ Veterans Recreation Center
 - Community Meeting, 6:30-8:30PM @ Veterans Recreation Center
- **Round 2 Outreach – June 3:**
 - Community Kiosk at San Bruno Community Day, 11:30AM-4:30PM @ City Park
- **June 26:** City Council Presentation



AGENDA

1. Summary Presentation

- Project Workplan
- Summary of Program + Site Options

2. Site Options

- Site Options Preview

3. Break Out Group Discussions

- Program Options
- Site Options
- Design Values
- Report Back

4. Next Steps

RECREATION DESIGN

The "Field house" Model – Athletic Focus



COMMUNITY RECREATION DESIGN

Community focus
All ages, whole family
Multi-cultural
Active and passive



Who Knew?

COMMUNITY RECREATION DESIGN

The only constant is change

No one knows what's next...



COMMUNITY RECREATION DESIGN

Then

Now

Athletics

- Gym
- Working out

Active and passive Recreation
Social
Broad appeal

Minimal creature comfort
Utilitarian
Compartmentalized
Heavily subsidized

Comfortable & Inviting
Both specific and Multi-functional use
Open & Transparent
Demand for cost recovery



BASE PROGRAM COMPONENTS



LOBBY/LOUNGE

- RECEPTION
- INFORMAL SOCIAL



GYMNASIUM

HIGH SCHOOL REGULATION COURT W/ 2 MINOR COURTS

- ACTIVE RECREATION
- FITNESS
- INFORMAL PLAY



FITNESS + WELLNESS

- DEDICATED SPACE FOR EQUIPMENT
- STUDIO FOR DANCE & GROUP EXERCISE CLASSES

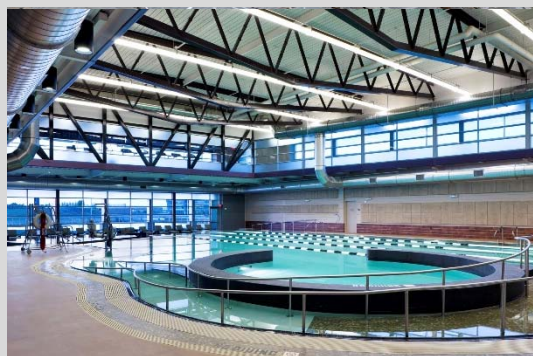

AQUATICS

- OUTDOOR 25-YARD RECREATION POOL
- INDOOR LEISURE POOL COMPONENT
- PARTY ROOMS (2 MEDIUM SIZED)



CLASSROOMS

30-36 PEOPLE

- LIFELONG LEARNING
- FORMAL EVENTS
- ENRICHMENT



CONFERENCE ROOM

16-20 PEOPLE

- SMALL GROUP MEETINGS



ART CLASSROOM

25-30 PEOPLE

- CREATIVE ARTS
- CRAFTS
- MAKER SPACE



EARLY CHILDHOOD EDUCATION

30-34 PEOPLE

- CAMP PROGRAMMING
- EXPANDED YOUTH ACTIVITIES

LOBBY + LOUNGE

Reception & informal gathering
BASE PROGRAM COMPONENTS



GROUP 4

DRAFT 03/22/18

14

SAN BRUNO RECREATION & AQUATICS CENTER
CONCEPTUAL DESIGN

GYMNASIUM

High school regulation and minor play courts; divisible
BASE PROGRAM COMPONENTS



FITNESS + WELLNESS

Fitness equipment and dance/group exercise space BASE PROGRAM COMPONENTS

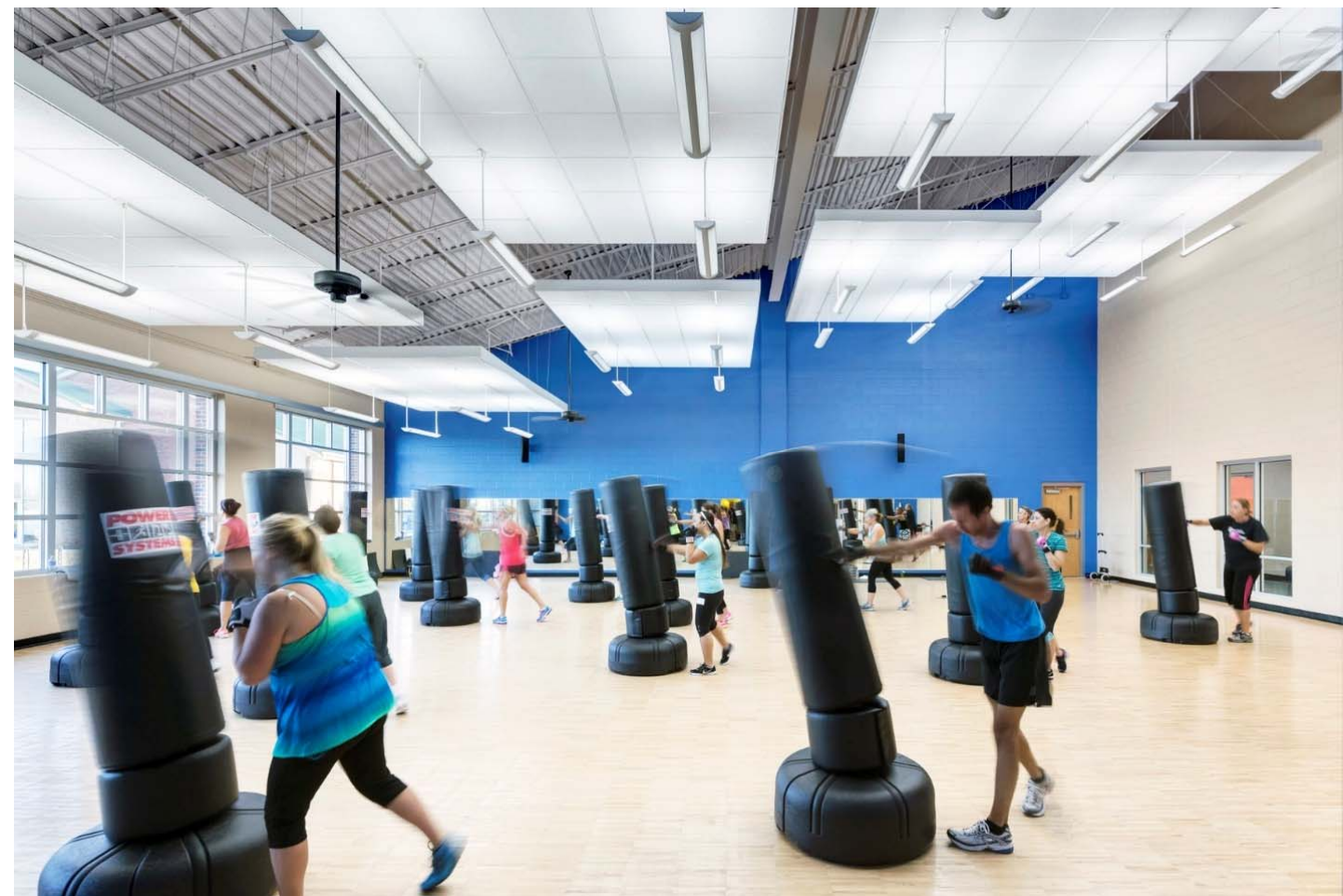
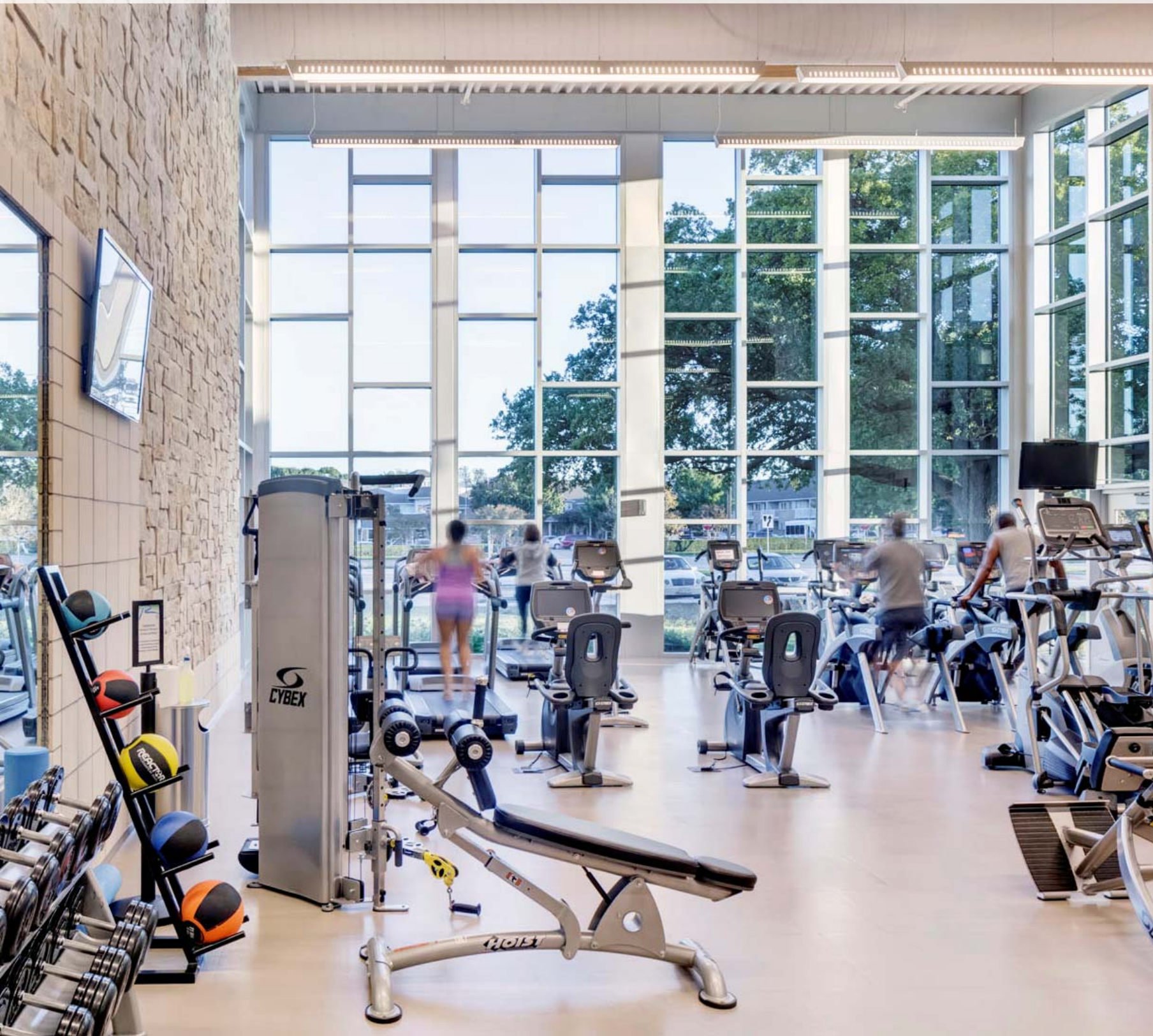

INDOOR POOL

leisure pool component; party rooms
BASE PROGRAM COMPONENTS

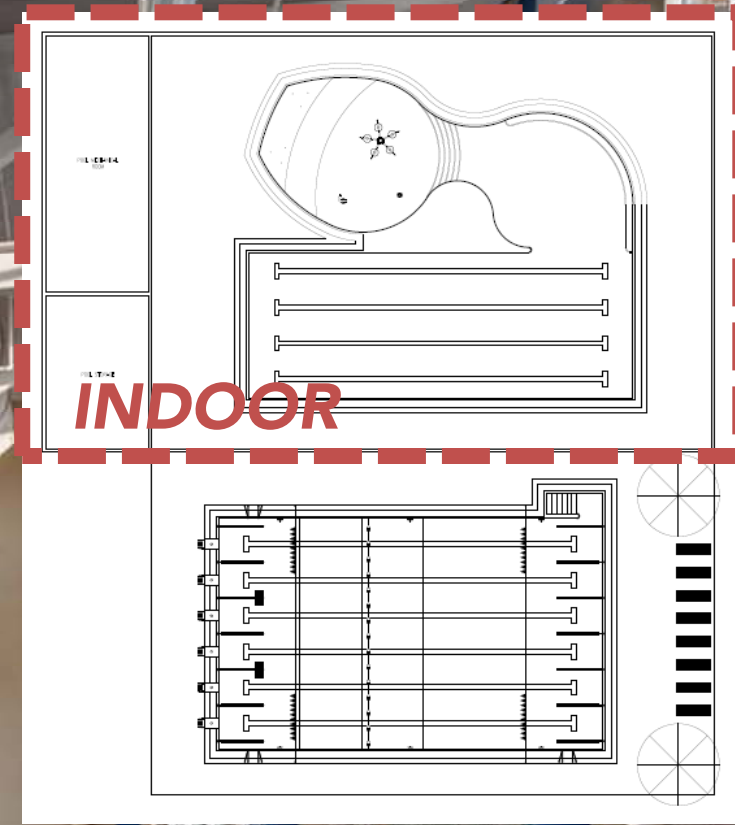

PARTY ROOM

OUTDOOR POOL

25-yard recreation pool
BASE PROGRAM COMPONENTS

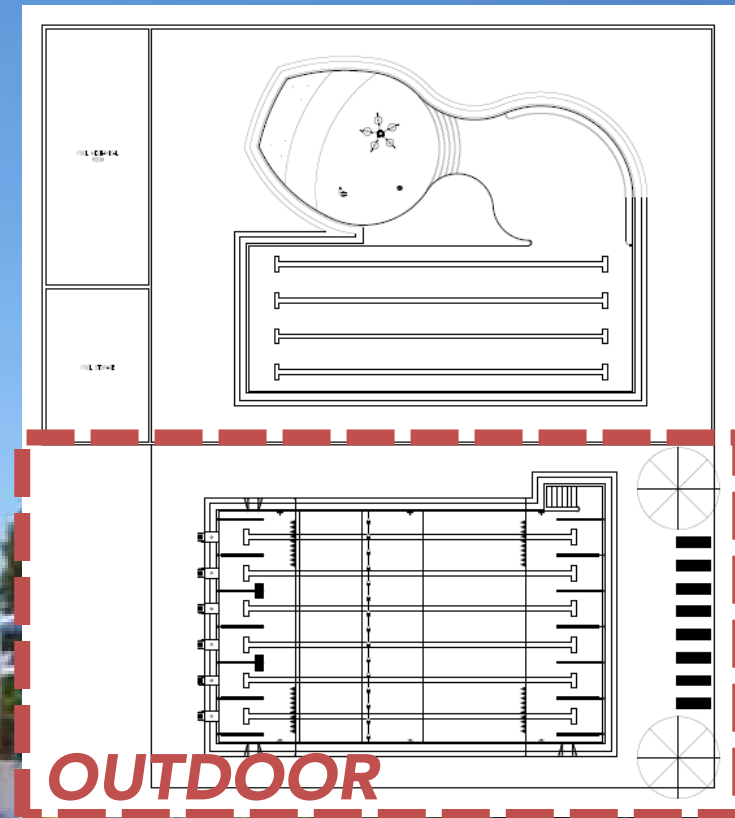

CLASSROOMS

Divisible space for lifelong learning, meetings, and enrichment
BASE PROGRAM COMPONENTS



CONFERENCE ROOM



Small group meetings and classes BASE PROGRAM COMPONENTS



ART CLASSROOM

Creative arts and crafts; maker activities
BASE PROGRAM COMPONENTS



EARLY CHILDHOOD EDUCATION

Summer camps and youth programming
BASE PROGRAM COMPONENTS



PROGRAM ENHANCEMENTS

BASE



ENHANCEMENTS

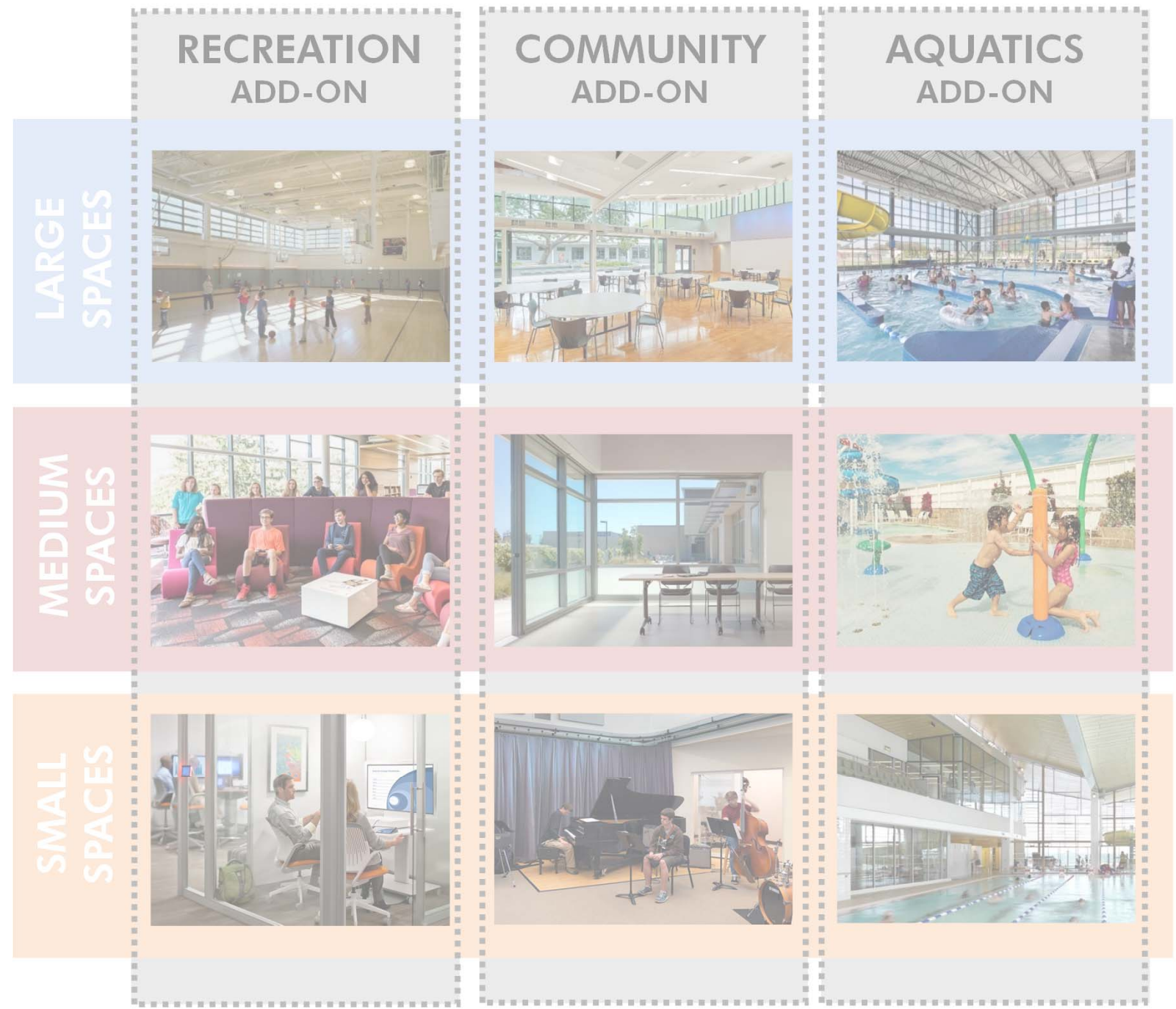

PROGRAM ENHANCEMENTS

BASE



RECREATION ADD-ON



COMMUNITY ADD-ON



AQUATICS ADD-ON



LARGE
SPACES

MEDIUM
SPACES

SMALL
SPACES



RECREATION ADD-ON



Small Gym (LRG)



PROGRAM ENHANCEMENT



Game Room (MED)



Consultation Room (SML)

COMMUNITY CENTER ADD-ON

PROGRAM ENHANCEMENT



Community Hall (LRG)



Additional Classrooms (MED)



Music Room (SML)

AQUATICS ADD-ON



Additional Leisure Pool (LRG)

PROGRAM ENHANCEMENT



Outdoor Water Play (MED)



Spectator Area (SML)

OVERALL OPERATIONS

Current Operations

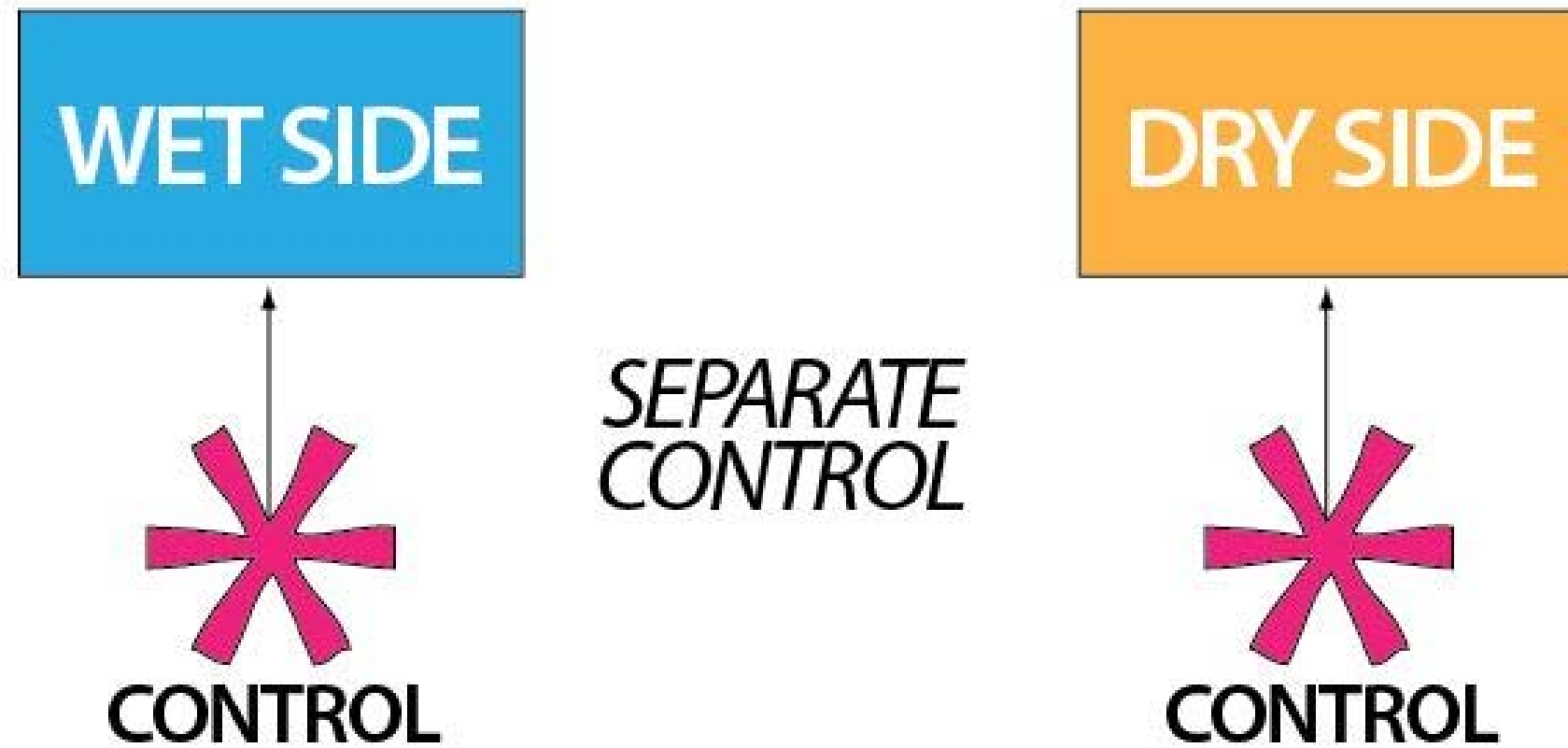

OVERALL OPERATIONS

Control Points

- More control points → more staff → more expense

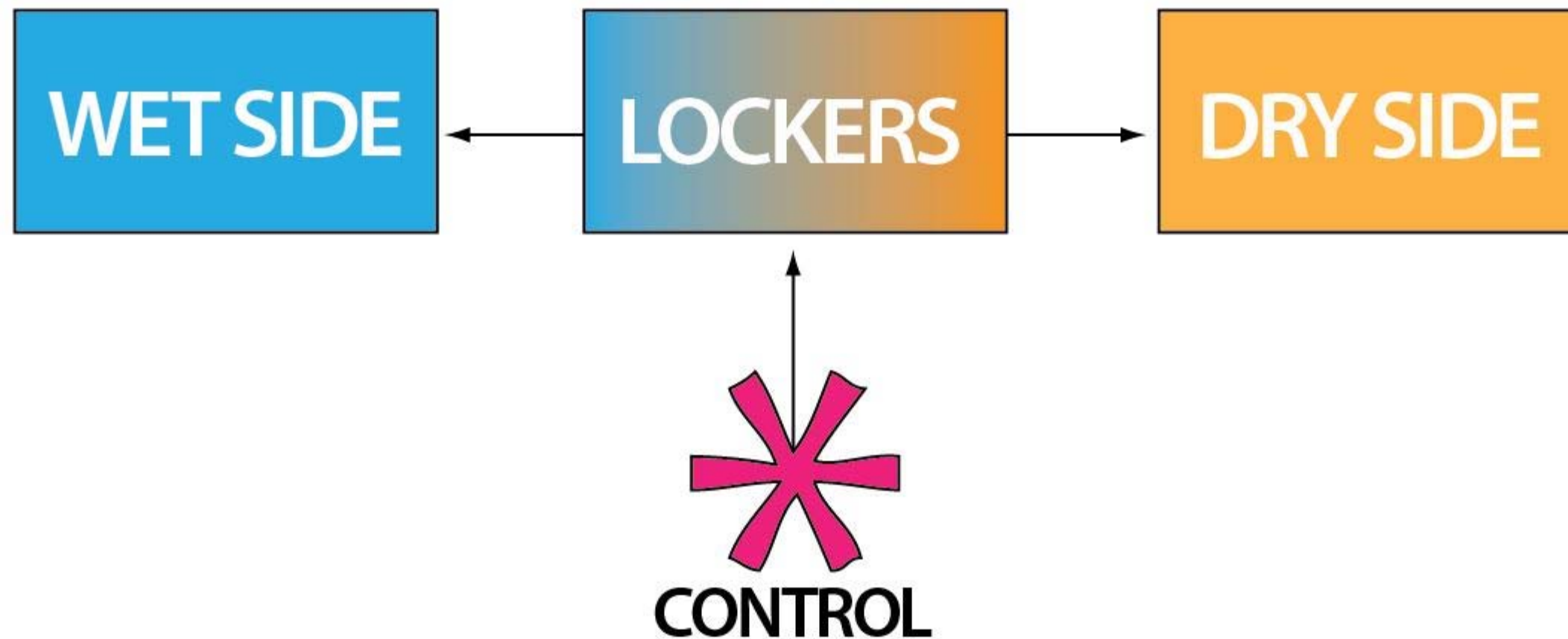

OVERALL OPERATIONS

Control Points

- Impact of secondary control points
- Operational flexibility
- Event control

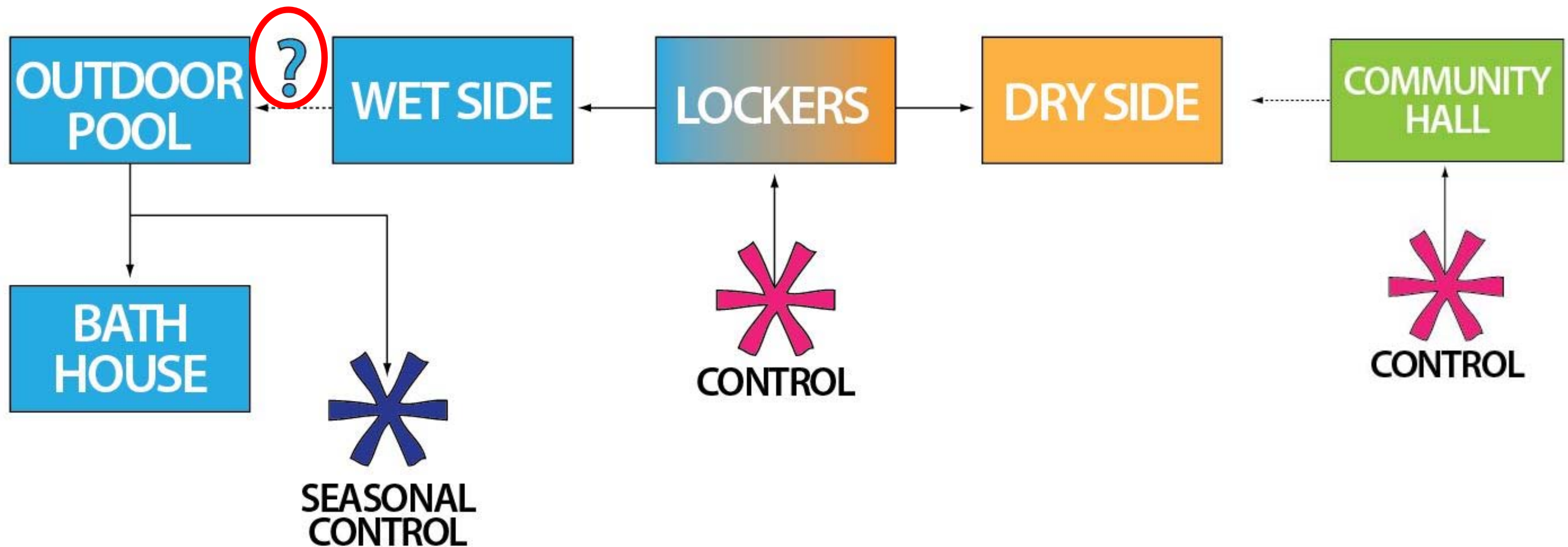



AGENDA

1. Summary Presentation
 - Project Workplan
 - Summary of Program + Site Options
2. Site Options
 - Site Options Preview
3. Break Out Group Discussions
 - Program Options
 - Site Options
 - Design Values
 - Report Back
4. Next Steps

An aerial photograph of a residential neighborhood with rolling hills in the background. A central road or path is highlighted with five green ovals of varying sizes, indicating specific site opportunities. The ovals are arranged in a roughly vertical line, with the largest one at the bottom and the smallest at the top. The surrounding area is densely packed with houses and trees.

SITE OPPORTUNITIES: NECKLACE OF PLACES







EXPAND REC & AQUATICS *and* ENHANCE PARK





SITE ALTERNATIVES



SITE STRATEGY INPUT



OPTION A
HILL "ALL NEW"

OPTION B
HILL "REUSE"

OPTION C
VALLEY

**Three great site and building options:
If all are feasible, which do you like?**

Select one, two, or all three. Why?

SITE STRATEGY INPUT



OPTION A
HILL "ALL NEW"

OPTION B
HILL "REUSE"

OPTION C
VALLEY

EVALUATION CRITERIA

ACCESSIBILITY

Is the site easy to get to, not only by car but by alternative modes of transportation? Are pedestrians and cyclists able to easily navigate to the facility? Is the circulation in and out of the site efficient, disruptive, or dangerous? Is the building easily accessible to parking?

VISIBILITY

Is the entrance and wayfinding to the Recreation & Aquatics Center site clear for visitors? Is the facility visible and easily identifiable as one enters City Park?

BUILDING/PARK RELATIONSHIP

How does the built form engage with the park? Is the open space and view corridors between overall park spaces well preserved? How well does the building support indoor-outdoor connections?



HILL ALTERNATIVE



HILL SCHEME OPTION
"ALL NEW"





EXISTING REUSE POTENTIAL



Glen Park Recreation Center, San Francisco

- Possible reuse of existing Veteran's Memorial Recreation Center, pending structural analysis
- Preserving the second level gym
- Potential to reuse ground floor as parking, converting interior spaces to storage, service, and/or other back-of-house spaces
- ~80-100%+(?) cost compared to new construction

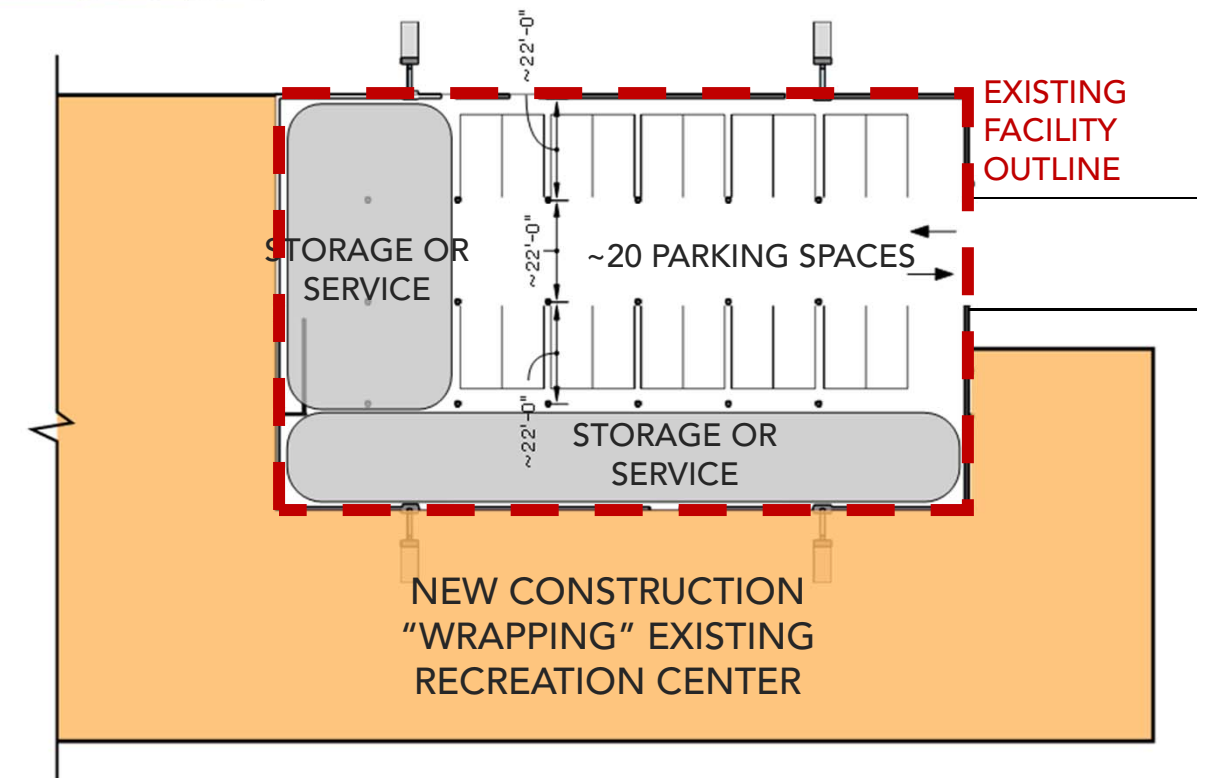

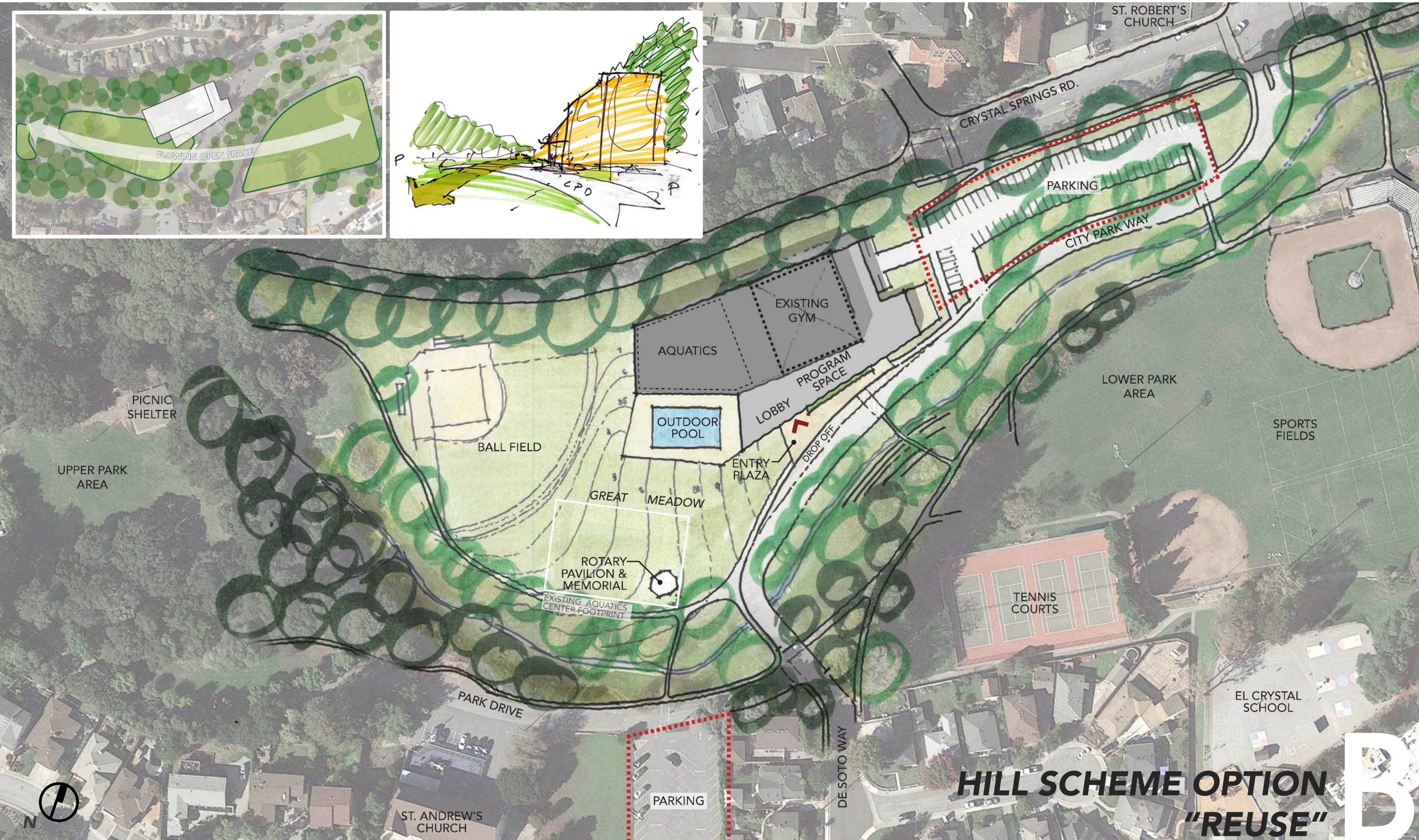

**HILL SCHEME OPTION
"REUSE"**

B



VALLEY ALTERNATIVE



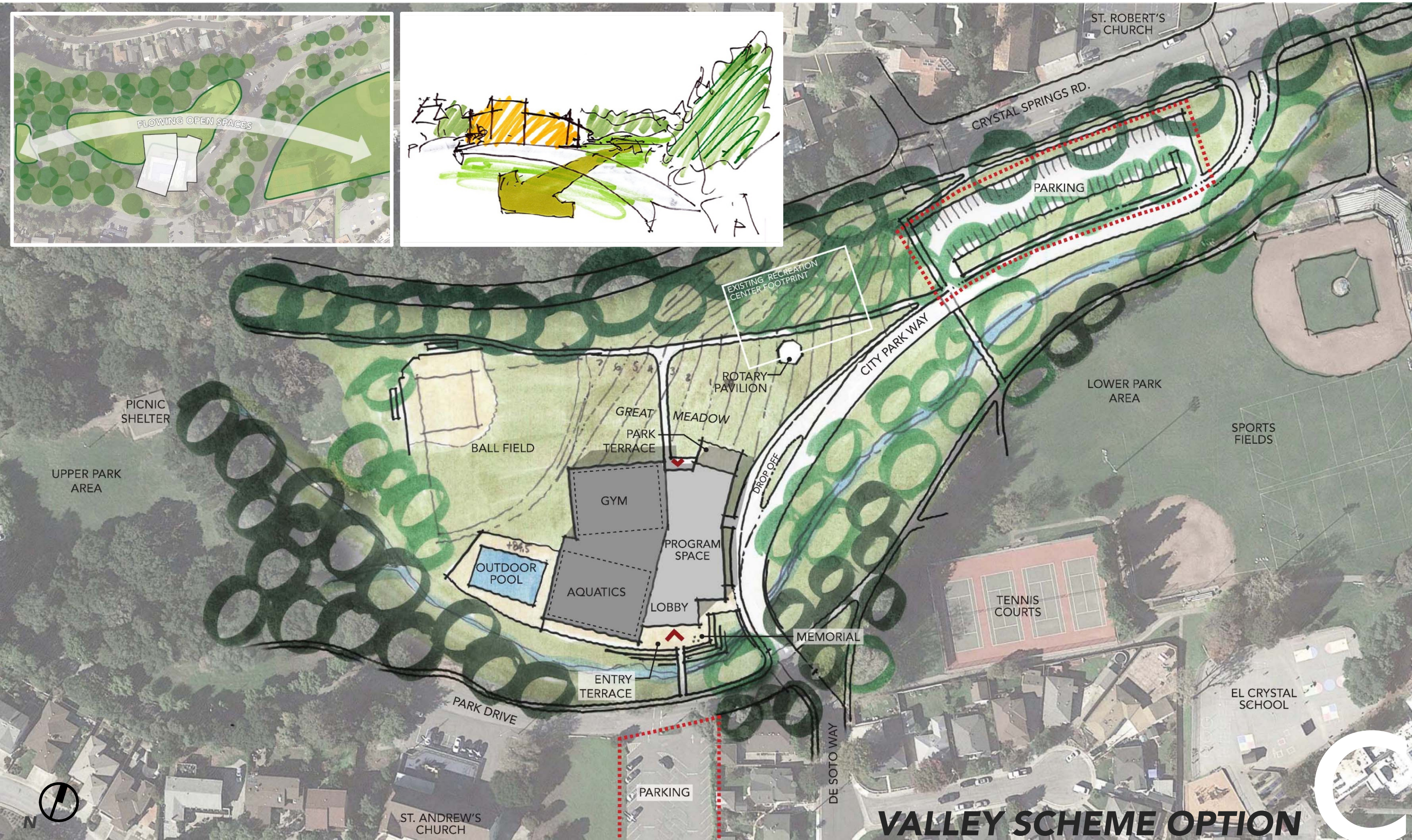

VALLEY SCHEME OPTION

QUESTIONS/COMMENTS?





AGENDA

1. Summary Presentation

- Project Workplan
- Summary of Program + Site Options

2. Site Options

- Existing Site Conditions and Parking
- Site Options Review

3. Break Out Group Discussions

- Program Options
- Site Options
- Design Values
- Report Back

4. Next Steps



AGENDA

1. Summary Presentation

- Project Workplan
- Summary of Program + Site Options

2. Site Options

- Existing Site Conditions and Parking
- Site Options Review

3. Break Out Group Discussions

- Program Options
- Site Options
- Design Values
- Report Back

4. Next Steps



AGENDA

1. Summary Presentation

- Project Workplan
- Summary of Program + Site Options

2. Site Options

- Existing Site Conditions and Parking
- Site Options Review

3. Break Out Group Discussions

- Program Options
- Site Options
- Design Values
- Report Back

4. Next Steps

NEXT STEPS – UPCOMING MEETINGS

- **Round 1 Outreach – March 24:**
 - Community Kiosk at the Pancake Breakfast & Easter Egg Hunt, 9AM-12PM @ Veterans Recreation Center and City Park
- **April 18:** Planning Commission Meeting
- **April 24:** City Council Presentation
- **Round 2 Outreach:**
 - **May 17:** Open House, 3-5PM; Community Meeting 6:30PM-8:30PM @ Veterans Memorial Recreation Center, Meeting Room
 - **June 3:** Community Kiosk at San Bruno Community Day, 11:30-4:30pm @ City Park

For more information and updates, visit the City's website:

<https://www.sanbruno.ca.gov/>

THANK YOU!