

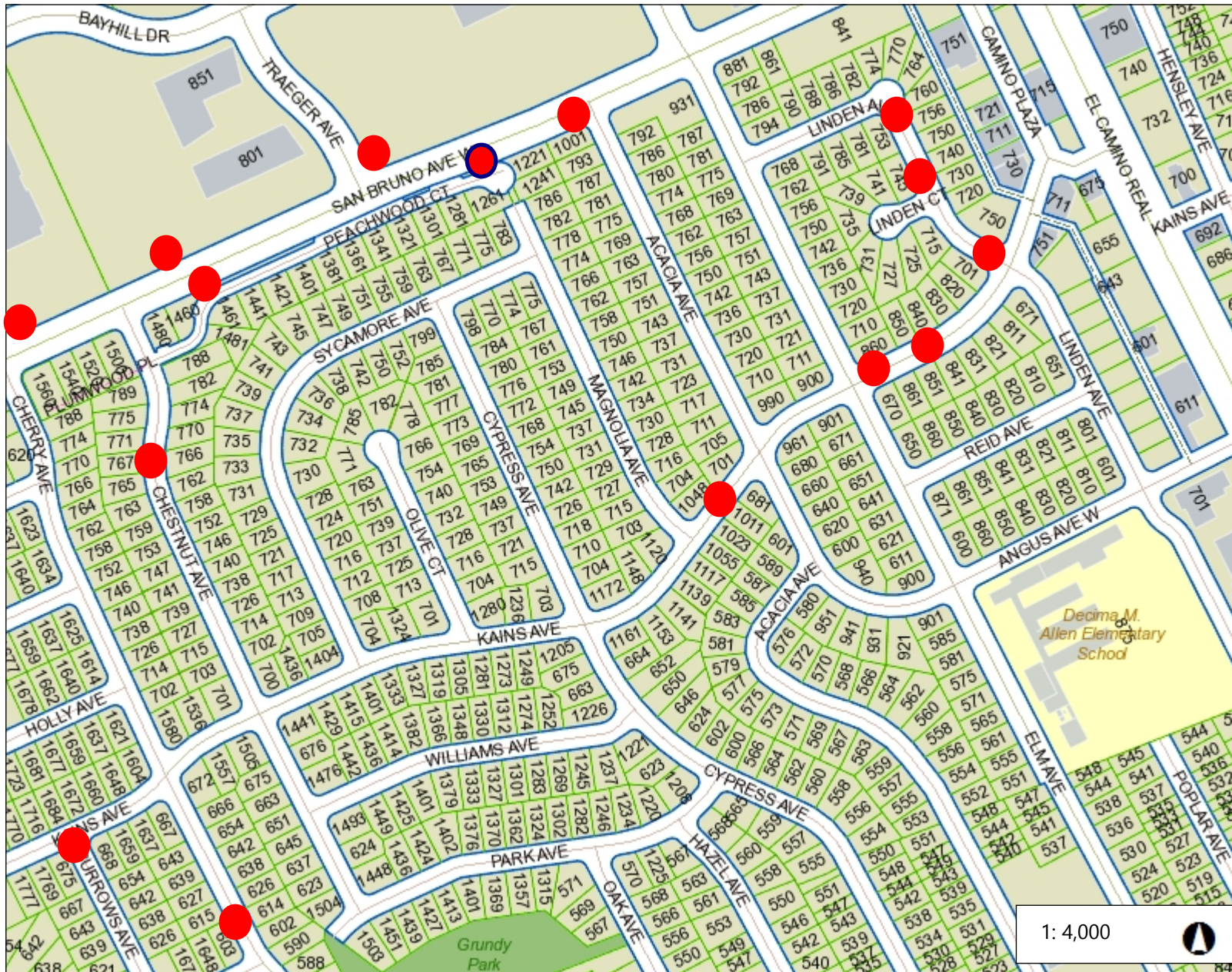

SUBSTANTIAL POLE REPLACEMENT PROJECT 00023 SBA, KAINS, LINDEN, BURROWS, CHERRY, Chestnut



Legend

- Street Names (4,500-1,500)
- Address
- City Limits
- Street Centerlines
 - Freeway
 - Arterial
 - Collector
 - Local
 - Alley
 - Private
 - Ramp
 - Trail
- Lotlines
 - Condominium 1st Floor
 - Condominium 2nd Floor
 - Condominium 3rd Floor
 - Condominium 4th Floor
 - Parcel
 - Right-of-Way
- San Francisco Bay
- City Park
- County Park
- Open Space
- State Park
- Wildland
- Place Of Worship
 - Caltrain
- San Mateo County
 - ATHERTON
 - BELMONT
 - BRISBANE
 - BRISBANE QUARRY
 - BROADMOOR
 - BURLINGAME
 - BURLINGAME HILLS
 - CALIFORNIA GOLF CLUB
 - COLMA

15 Poles total

Notes

San Bruno Ave NS E of Traeger, 1001 SBA, N-side btwn Cherry & Traeger SBA, NS E of Cherry x SBA, 1461, 1261 SBA, 840, 860, 1011 Kains, 701, 745, 753 Linden, 675 Burrows. 603 Cherrv. 767 Chestnut

666.7 0 333.33 666.7 Feet

NAD_1983_StatePlane_California_III_FIPS_0403_Feet
City of San Bruno IT/GIS Services

This map is for reference only. The City of San Bruno and its agents are not responsible for any errors, omissions or misuse. Users should contact city staff directly to verify content hereon.



Streetlight Pole Replacement Project 60025 SMA 1



Legend

- Street Names (4,500-1,500)
- Address
- City Limits
- Street Centerlines
 - Freeway
 - Arterial
 - Collector
 - Local
 - Alley
 - Private
 - Ramp
 - Trail
- Lotlines
 - Condominium 1st Floor
 - Condominium 2nd Floor
 - Condominium 3rd Floor
 - Condominium 4th Floor
 - Parcel
 - Right-of-Way
- San Francisco Bay
 - City Park
 - County Park
 - Open Space
 - State Park
 - Wildland
- Place Of Worship
 - Caltrain
- San Mateo County
 - ATHERTON
 - BELMONT
 - BRISBANE
 - BRISBANE QUARRY
 - BROADMOOR
 - BURLINGAME
 - BURLINGAME HILLS
 - CALIFORNIA GOLF CLUB
 - COLMA

1: 2,000



333.3 0 166.67 333.3 Feet

NAD_1983_StatePlane_California_III_FIPS_0403_Feet
City of San Bruno IT/GIS Services

This map is for reference only. The City of San Bruno and its agents are not responsible for any errors, omissions or misuse. Users should contact city staff directly to verify content hereon.

Notes

San Mateo Avenue 828, 860, 898, 900

4 Poles total



Streetlight Pole Replacement Project 60025 San Bruno W

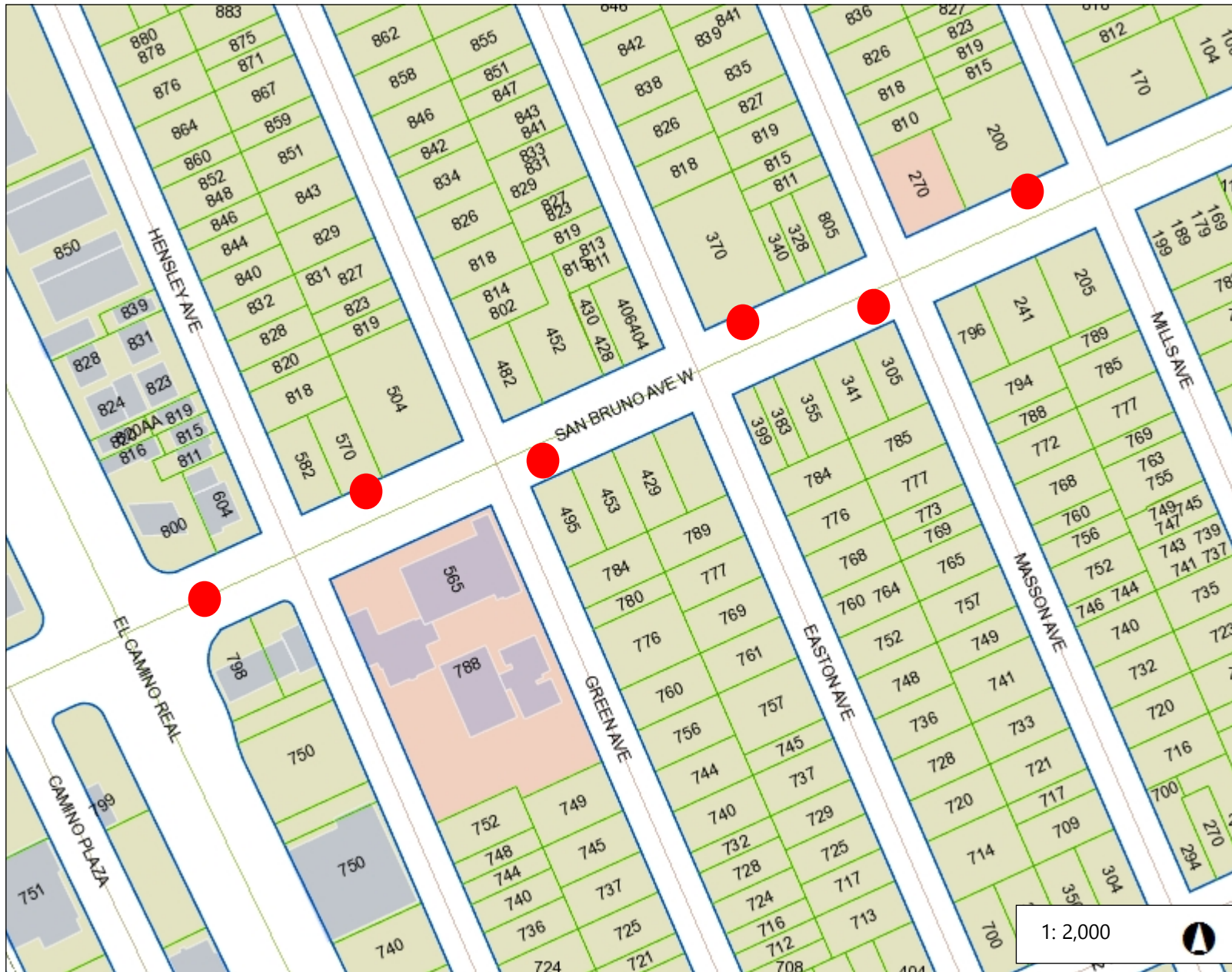

Legend

- Street Names (4,500-1,500)
- Address
- City Limits
- Street Centerlines
 - Freeway
 - Arterial
 - Collector
 - Local
 - Alley
 - Private
 - Ramp
 - Trail
- Lotlines
 - Condominium 1st Floor
 - Condominium 2nd Floor
 - Condominium 3rd Floor
 - Condominium 4th Floor
 - Parcel
 - Right-of-Way
- San Francisco Bay
 - City Park
 - County Park
 - Open Space
 - State Park
 - Wildland
- Place Of Worship
 - Caltrain
- San Mateo County
 - ATHERTON
 - BELMONT
 - BRISBANE
 - BRISBANE QUARRY
 - BROADMOOR
 - BURLINGAME
 - BURLINGAME HILLS
 - CALIFORNIA GOLF CLUB
 - COLMA

1: 2,000



333.3 0 166.67 333.3 Feet

NAD_1983_StatePlane_California_III_FIPS_0403_Feet
City of San Bruno IT/GIS Services

This map is for reference only. The City of San Bruno and its agents are not responsible for any errors, omissions or misuse. Users should contact city staff directly to verify content hereon.

Notes

**SBAW 200, 305, 370,
495, 570, 798
6 Poles total**



Streetlight Pole Replacement Project 60025 SMA 2

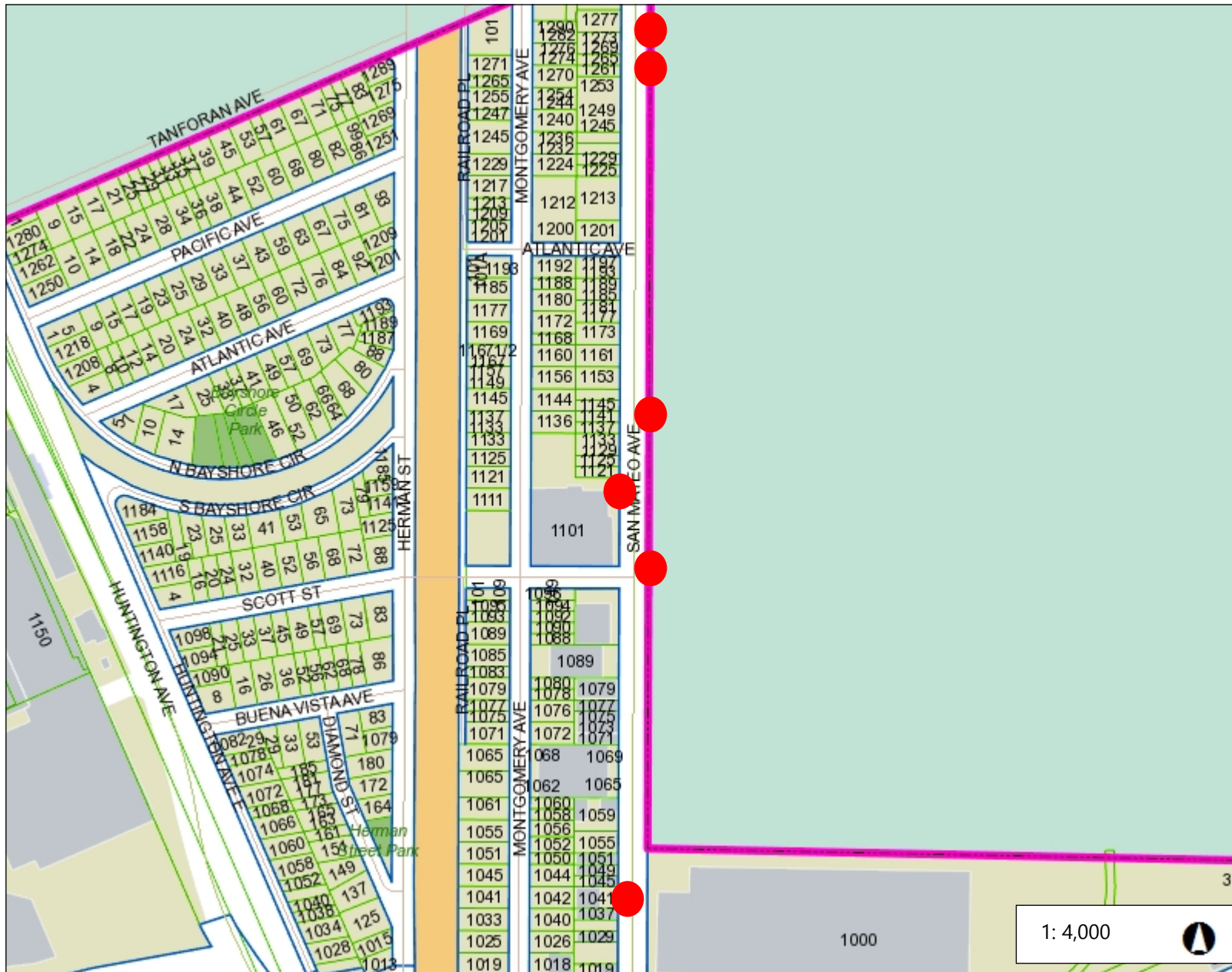

Legend

- Street Names (4,500-1,500)
- Address
- City Limits
- Street Centerlines
 - Freeway
 - Arterial
 - Collector
 - Local
 - Alley
 - Private
 - Ramp
 - Trail
- Lotlines
 - Condominium 1st Floor
 - Condominium 2nd Floor
 - Condominium 3rd Floor
 - Condominium 4th Floor
 - Parcel
 - Right-of-Way
- San Francisco Bay
 - City Park
 - County Park
 - Open Space
 - State Park
 - Wildland
- Place Of Worship
 - Caltrain
- San Mateo County
 - ATHERTON
 - BELMONT
 - BRISBANE
 - BRISBANE QUARRY
 - BROADMOOR
 - BURLINGAME
 - BURLINGAME HILLS
 - CALIFORNIA GOLF CLUB
 - COLMA

1: 4,000



666.7 0 333.33 666.7 Feet

NAD_1983_StatePlane_California_III_FIPS_0403_Feet
City of San Bruno IT/GIS Services

This map is for reference only. The City of San Bruno and its agents are not responsible for any errors, omissions or misuse. Users should contact city staff directly to verify content hereon.

Notes

San Mateo Avenue 1100, 1140, 1266, 1272, AF1041, AF1121

6 Poles total